

## HIGH VOLUME SHIPMENT

### SECTION A

### RECEIVING SHIPPER

#### STEP 1

#### UNLATCHING INSTRUCTIONS



Once the shipper has arrived, remove old shipping pouch and zip-ties.

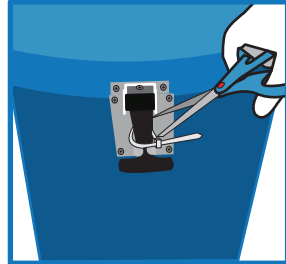

Remove zip-ties from both black handles with scissors.

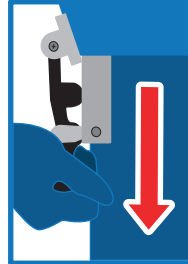

Unlatch both sides by pulling black handle down & away from the shipper.

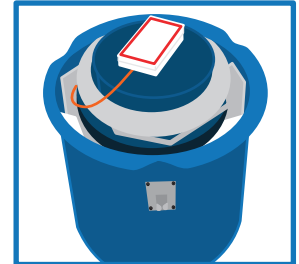
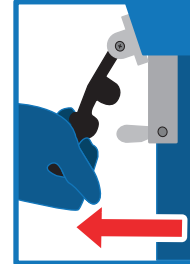

Open lid to expose the dewar.

**IMPORTANT NOTE:** Commodity and accessories must be pre-conditioned prior to loading into the sample chamber. A **20% reduction of holding time** can occur if the materials are not preconditioned prior to loading into the shipper.

### SECTION B

### PACKING THE SPECIMEN

#### STEP 1

#### LOADING SAMPLES TO BE SHIPPED INTO EITHER:

**Cryovial Box**  
Holds 30 (2ml) vials.

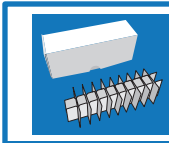

**Canes**  
Holds 5 (2ml) vials.

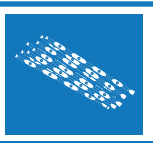

ACC-9139



ACC-9140

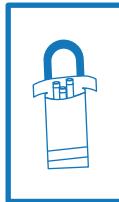

**Safepak®** Holds 15 canes or 2 (5 1/2" x 2" x 2") boxes. 7 bags can be loaded into the dewar.

**Safepak® XL**  
Holds multiple payloads.

**Cryostrap®**  
Use alone or with the Safepak® XL to secure blood cassettes and cryovial boxes.

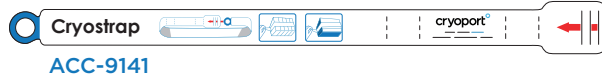

ACC-9141

ACC-10502



**Cassette Rack**  
Holds 9 (9.5" x 6" x 0.5") cassettes.

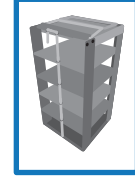

**Box Rack**  
Holds 5 (5 3/8" x 2 1/4") or 10 (5 1/2" x 2" x 2") boxes.

ACC-10521

### SECTION C

### LOADING SAMPLES FOR SHIPMENT

#### STEP 1

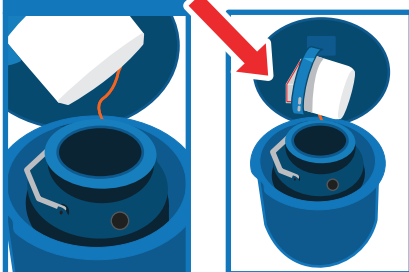

Once the specimen is packaged, remove the lid and rest it sideways behind the dewar and against the blue enclosure lid.

#### STEP 2

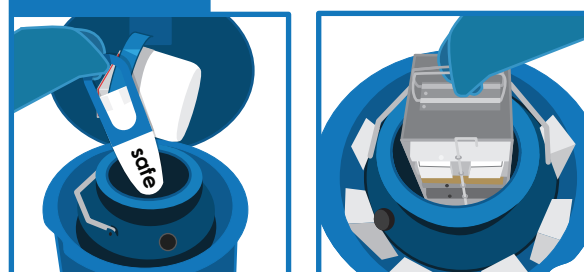

Lower the packaged commodity into the dewar with gloved hands.

#### STEP 3



If your commodity is loaded in a rack, ensure the handles are laying flat against the top.

**IF THE DRY SHIPPER DOES NOT EMIT VAPOR WHEN PLUG IS REMOVED**  
PLEASE CONTACT CUSTOMER SERVICE IMMEDIATELY, BY CALLING (949) 470-2305 OR EMAIL CS@CRYOPORT.COM

## HIGH VOLUME SHIPMENT

### SECTION D

### PACKAGING THE SHIPMENT

#### STEP 1

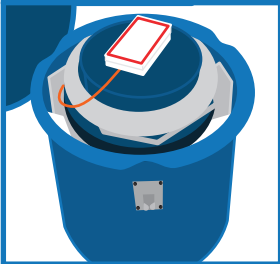

Replace the dewar lid.

#### STEP 2

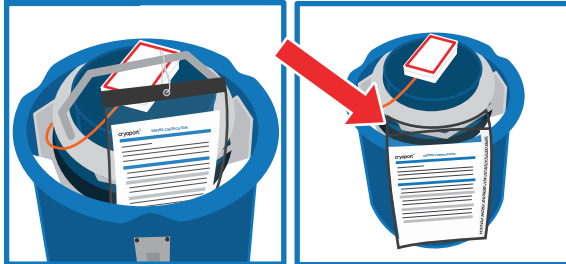

Remove the Leg 1 shipping pouch from document protector attached to the dewar handle inside of the container.

#### STEP 3

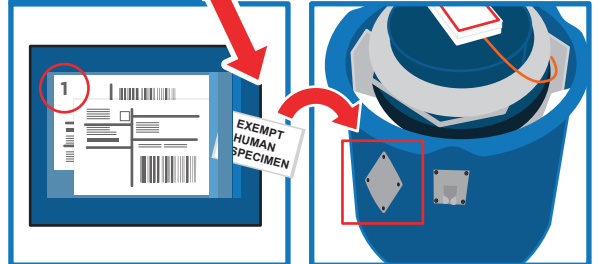

Remove any classification labels from the shipping pouch and place on the metal diamond.

#### STEP 4

Remove the commercial Invoices located in the shipping pouch.

##### International Shipments ONLY

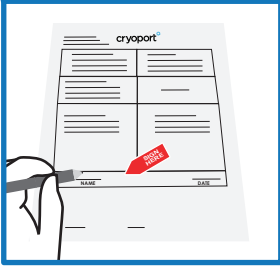

1. Sign and date.



2. Return all documents being shipped behind the Air Waybill including any: Permits, Forms, Licenses, etc.

#### STEP 5

Once all documents are loaded:



1. Close the shipping pouch and remove sticker backing.



2. Place shipping pouch on metal plate.



3. Close lid.

#### STEP 6

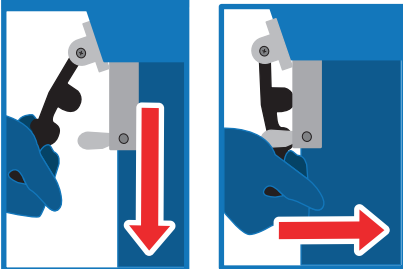

Latch handle on both sides by pulling the black handle down & then towards the shipper.

#### STEP 7

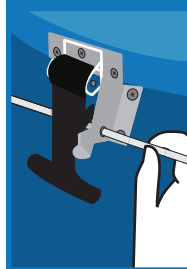

Insert zip-tie through one of the holes on the metal latch hardware.



Thread end of zip-tie through the hole on the other side of the metal hardware.

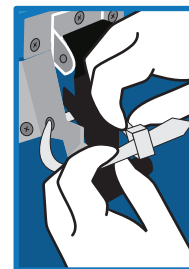

Insert zip-tie through the lid buckle and tighten.

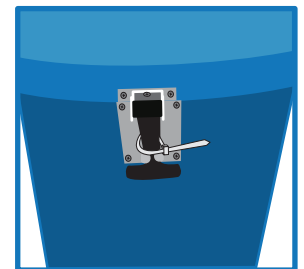

Zip-tie is now securely around the black handle.

For those shipments containing regulated dangerous goods/hazardous materials, the shipper is responsible for correctly preparing the shipment according to the current International Air Transport Association (IATA) and International Civil Aviation Organization (ICAO) dangerous goods regulations.

This includes correct identification, classification, packaging, dangerous goods markings and labeling as well as completion of all pertinent and required documentation. The shipper is the customer who is preparing the shipment at each leg in the transportation of the dry dewar packaging.

24-hour Help Line  
(949) 470-2305

Cryoport, Inc. • 17305 Daimler St. • Irvine, CA 92614  
Phone: 1-949-470-2300 | Fax: 1-949-470-2306  
www.cryoport.com • e-mail contact: cs@cryoport.com