

## HIGH VOLUME SHIPMENT

### SECTION A

### RECEIVING SHIPPER

#### STEP 1

#### UNLATCHING INSTRUCTIONS



Once the shipper has arrived, remove old shipping pouch and zip-ties.

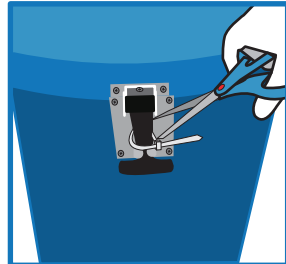

Remove zip-ties from both black handles with scissors.

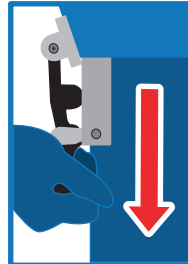

Unlatch both sides by pulling black handle down & away from the shipper.

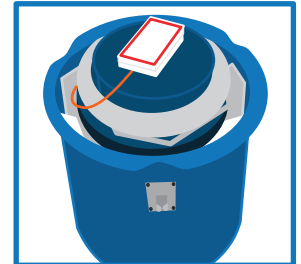
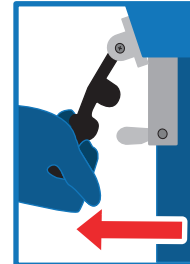

Open lid to expose the dewar.

### SECTION B

### PREPARING THE SAFEPAK®XL (Please refer to Cryostrap® Instructions)

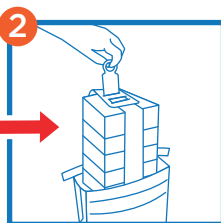
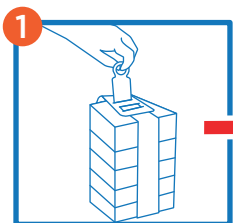

Open Bag and insert one rack into top opening. Lower rack completely into bag.

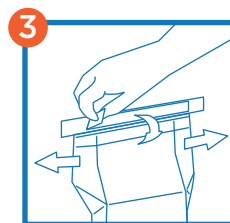

Flatten top section of pouch. Remove cover from adhesive strip, fold along crease (Detail A) and seal bag.

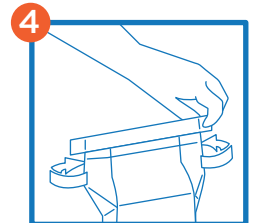

Fold tabs around edges and seal.

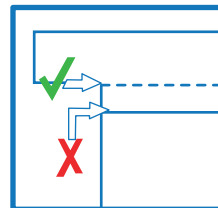
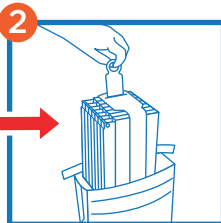
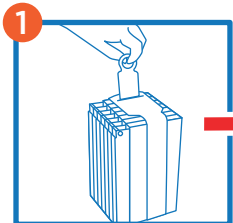

Detail A (close up of crease)

### SECTION C

### LOADING SAMPLES FOR SHIPMENT



Load the Safepak@XL into the Dewar



Allow it to sit in the bottom of the Dewar

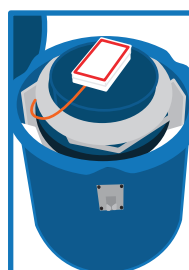

Replace the dewar lid.

**IMPORTANT NOTE:** Commodity and accessories must be pre-conditioned prior to loading into the sample chamber. A **20% reduction of holding time** can occur if the materials are not preconditioned prior to loading into the shipper.

**IF THE DRY SHIPPER DOES NOT EMIT VAPOR WHEN PLUG IS REMOVED**  
PLEASE CONTACT CUSTOMER SERVICE IMMEDIATELY, BY CALLING (949) 470-2305 OR EMAIL CS@CRYOPORT.COM

**HIGH VOLUME SHIPMENT**

**SECTION D**

**PACKAGING THE SHIPMENT**

**STEP 1**



Remove documents from the shipping pouch #1.

Remove any classification labels from the shipping pouch and place on the metal diamond.

**STEP 2**

Remove the commercial Invoices located in the shipping pouch.

**International Shipments ONLY**

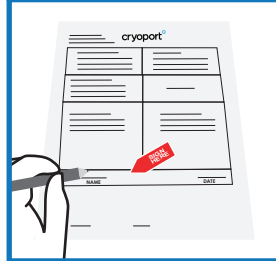

1. Sign and date.



2. Return all documents being shipped behind the Air Waybill Including any: Permits, Forms, Licenses, etc.

**STEP 3**

Once all documents are loaded:

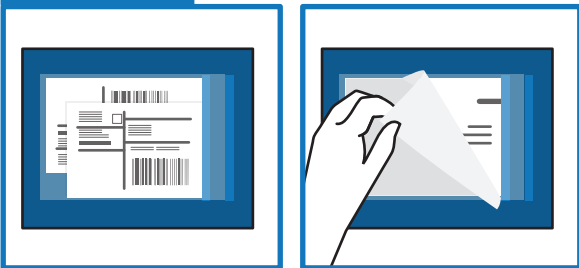

1. Close the shipping pouch and remove sticker backing.



2. Place shipping pouch on the metal plate.



3. Close lid.

**STEP 4**

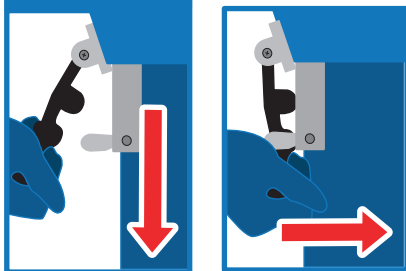

Latch handle on both sides by pulling the black handle down & then towards the shipper.

**STEP 5**

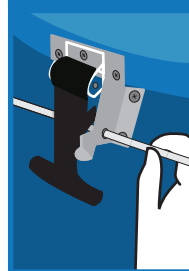

Insert zip-tie through one of the holes on the metal latch hardware.



Thread end of zip-tie through the hole on the other side of the metal hardware.



Insert zip-tie through the lid buckle and tighten.



Zip-tie is now securely around the black handle.

For those shipments containing regulated dangerous goods/hazardous materials, the shipper is responsible for correctly preparing the shipment according to the current International Air Transport Association (IATA) and International Civil Aviation Organization (ICAO) dangerous goods regulations.

This includes correct identification, classification, packaging, dangerous goods markings and labeling as well as completion of all pertinent and required documentation. The shipper is the customer who is preparing the shipment at each leg in the transportation of the dry dewar packaging.