

# C3™ 2-8°C & 15-25°C (CRT) SHIPPER

## How to Load Samples for Shipment



### Step 1

Be sure to wear the appropriate personal protective equipment (PPE) when handling products and shipping systems with extreme temperatures.



### Step 2

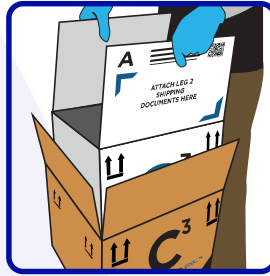

Remove the inner white box from the outer brown box by pulling up on the 2 flaps (marked A & B). Discard the outer brown box.

### Step 3



When opening the box, be sure not to puncture the Vacuum Insulated Panel (VIP) in the shipping system. Puncturing the VIP will affect the shipping system's hold time. Once open, remove the top VIP.

### Step 4



Remove the top Phase Change Panel (PCP).

### Step 5



Once the top Phase Change Panel is removed, you will have access to the specimen chamber to load your payload.

### Step 6

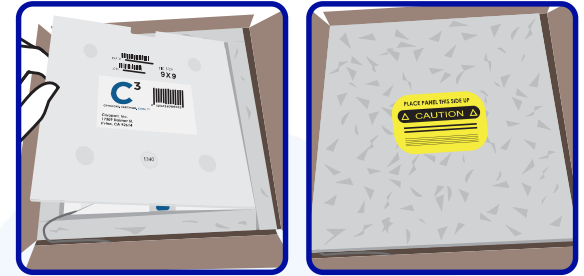

Once the payload has been loaded, replace the Phase Change Panel first, followed by the Vacuum Insulated Panel.

### Step 7



For international shipments:

- Remove all four (4) copies of the Commercial Invoices
- Sign all four (4) copies.
- Place all four (4) signed copies of the Commercial Invoices inside the shipping envelope on flap "A" behind the Air Waybill.

### Step 8



Close flap "B" first and make sure flap "A" is showing on the outside of the white carton. Place the Leg 2 pouch with Air Waybill in the designated area of the flap.

### Step 9

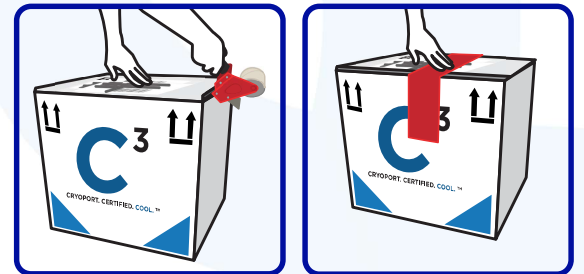

Seal the top of the white carton with packaging tape making sure to have flap "A" showing on the outside of the white carton. If the optional tamper evident seal (ACC-9041) is used, place it vertically across the top of flap "A" and the base of the white carton.