

CRYOPORT EXPRESS® CRYOGENIC ST1 SHIPPING SYSTEM



LN2 Refill Without Samples Inside Instructions

NEED HELP? CONTACT CRYOPORT SYSTEMS' CLIENT CARE AT (949) 470-2305 OR EMAIL CS@CRYOPORT.COM

Step 1



Wear the appropriate Personal Protective Equipment (PPE) when handling cryogenic shipments.

Step 2

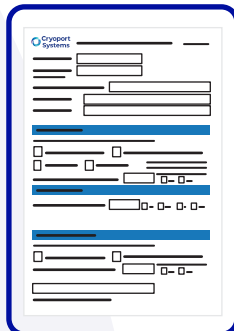

Contact Cryoport Systems' Client Care to access the In-Field Recharging Verification Form and complete Section A.

Step 3

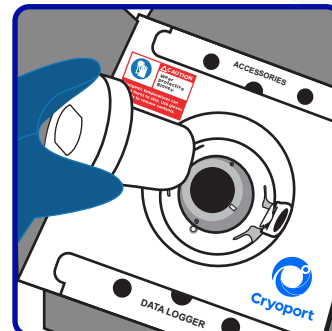

Carefully remove the vapor plug and set it aside with the fleece lining facing up.

Step 4



Slowly pour liquid nitrogen into the opening. (Cryoport Client Care will provide information on the amount of LN2 to use for your specific use case).

Step 5

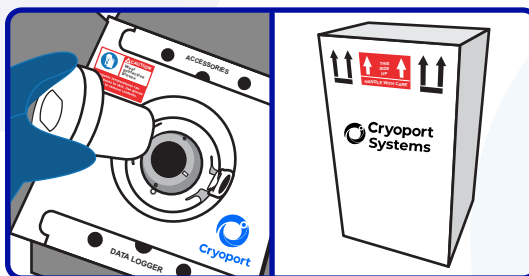

Reinsert the vapor plug and let the shipping system stabilize in a static position for at least 60 minutes.

Step 6

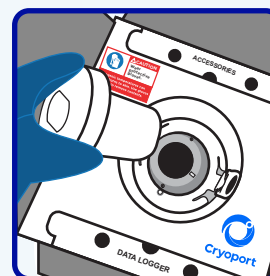

Once the shipping system has stabilized, remove the vapor plug and set it aside with the fleece lining face up.

NOTE: Avoid spilling LN2 on the data logger. The LN2 should absorb into the shipping system and excess LN2 should not be visible.

Step 7



Safely pour the excess LN2 into a compatible LN2 container.

NOTE: This process may take two people to complete. Follow local safety regulations associated with proper lifting.

Step 8

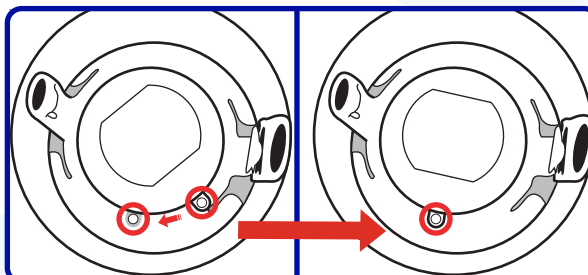

Reinsert the vapor plug. Ensure the tab on the vapor plug aligns with the gray tab on the dewar.

CRYOPORT EXPRESS® CRYOGENIC ST1 SHIPPING SYSTEM

LN2 Refill Without Samples Inside Instructions



NEED HELP? CONTACT CRYOPORT SYSTEMS' CLIENT CARE AT (949) 470-2305 OR EMAIL CS@CRYOPORT.COM

Step 9



Place the smaller circular handle under the other strap and push through the slit.

Press your thumb on the "PUSH" tab and slide the smaller strap through it, underneath the green check mark.

Place the "PUSH" tab behind the green check mark tab. The green check mark should be visible when secured.

Step 10

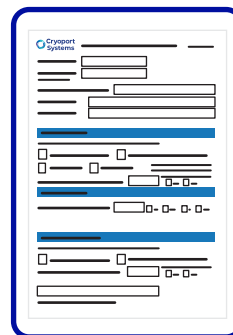

Complete Section C and D of the In-Field Recharging Verification Form.