

CRYOPORT EXPRESS® CRYOGENIC STI SHIPPING SYSTEM



Eggs, Sperm, and Embryos Shipment Unloading Instructions

NEED HELP? CONTACT CRYOPORT SYSTEMS' CLIENT CARE AT (949) 470-2305 OR EMAIL CS@CRYOPORT.COM

Step 1

Be sure to wear the appropriate personal protective equipment (PPE) when handling cryogenic shipments.



Step 2

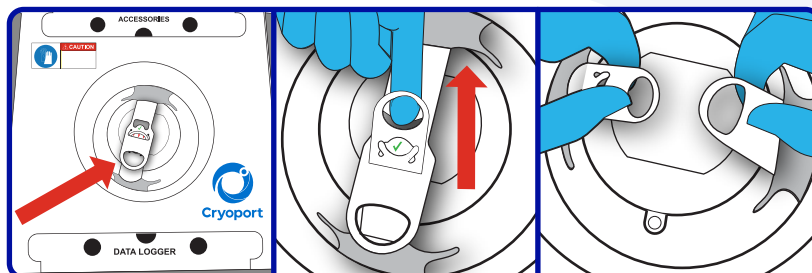

Locate the retention band featured above the vapor plug. Pull the small circular handle upward to release the retention band's locking tab. Then unlatch and separate the straps.

Step 3

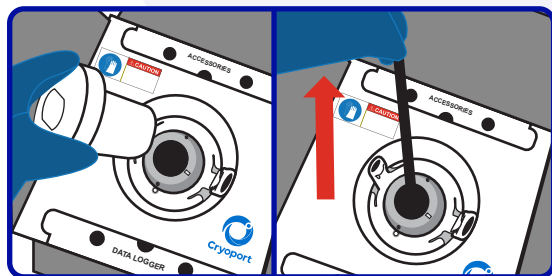

Remove the vapor plug and set it aside with the fleece lining facing up. Carefully lift the packaged commodity out of the shipping system and place it on a flat surface.

Step 4

Daisy Goblet 65mm ONLY

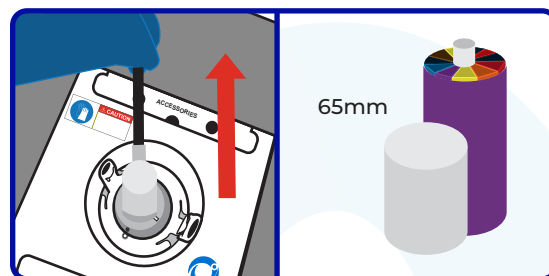

If the commodity is loaded in a 65 mm goblet (Daisy Goblet), pull the black strap up to expose the top of the goblet and remove the goblet.

Step 5

One Goblet or Vial on Cane ONLY

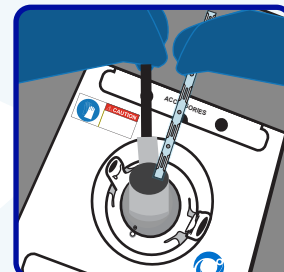
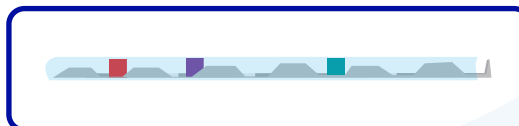
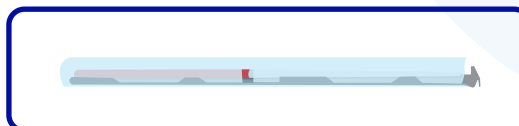
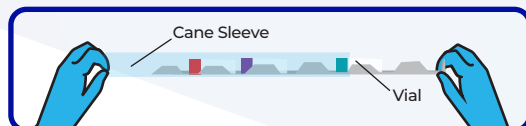
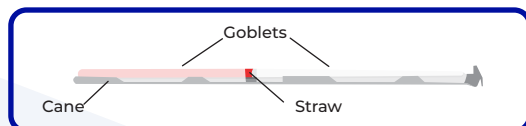

If the commodity is loaded in a goblet or vial on a cane, pull the black strap up to expose the top of the goblet and remove the cane.

NOTE: Place the goblet with lifter or canister back into the dewar to be returned to Cryoport Systems.

CRYOPORT EXPRESS® CRYOGENIC STI SHIPPING SYSTEM



Eggs, Sperm, and Embryos Shipment Unloading Instructions

NEED HELP? CONTACT CRYOPORT SYSTEMS' CLIENT CARE AT (949) 470-2305 OR EMAIL CS@CRYOPORT.COM

Step 6



Reinsert the vapor plug.

NOTE: Please remove all materials except the canister from the empty dewar. If other items are returned, there will be a penalty fee.

Step 7

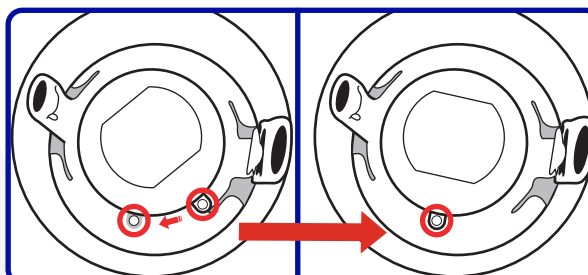

Ensure the tab on the vapor plug aligns with the gray tab on the dewar.

Step 8

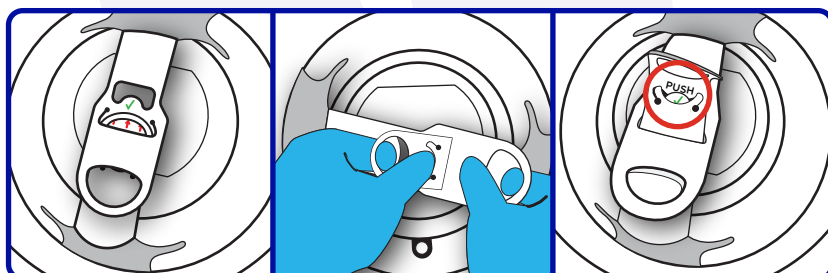

Place the smaller circular handle under the other strap and push through the slit.

Press your thumb on the "PUSH" tab and slide the smaller strap through it, underneath the green check mark.

Place the "PUSH" tab behind the green check mark tab. The green check mark should be visible when secured.

Step 9



Place the enclosed "EMPTY" label on the diamond. Remove the WARNING insert from inside of the shipping envelope on Flap "B". Only throw away the WARNING insert.

CRYOPORT EXPRESS® CRYOGENIC STI SHIPPING SYSTEM



Eggs, Sperm, and Embryos Shipment Unloading Instructions

NEED HELP? CONTACT CRYOPORT SYSTEMS' CLIENT CARE AT (949) 470-2305 OR EMAIL CS@CRYOPORT.COM

Step 10 For International Shipments ONLY



Sign and date the commercial invoices located in the shipping envelope.



Return all shipping documents inside shipping envelope on Flap "B," behind the Air Waybill, including any permits, forms, licenses, etc.

Step 11

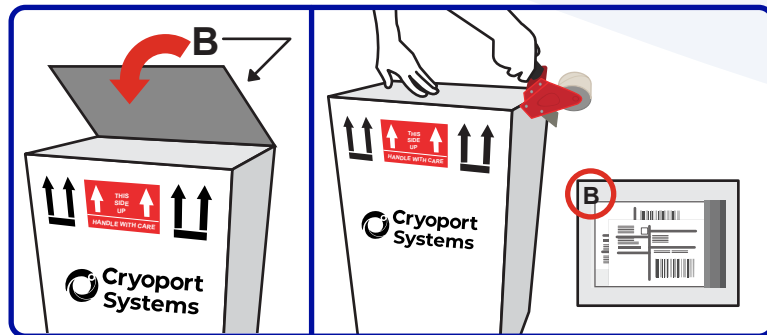

Close and seal the top of the box with packaging tape ensuring that Flap "B" is visible on the outside of the shipping system. The sealed envelope should be placed in the designated area on Flap "B."

NOTE: Please return empty shipping systems to Cryoport within 24 hours.